

THESE DRAWINGS AND SPECIFICATIONS ARE THE PROPERTY OF JBL INCORPORATED. THEY ARE ISSUED IN STRICT CONFIDENCE AND SHALL NOT BE REPRODUCED OR USED AS THE BASIS FOR MANUFACTURE OR APPARATUS WITHOUT WRITTEN PERMISSION.

ALL MATERIAL SPECIFIED ON THIS DRAWING SHALL COMPLY WITH EUROPEAN DIRECTIVE 2002/95/EC. [6013]

REVISIONS					
CHG.	DATE	DESCRIPTION	DRAWN	D.C.	DATE
37930	A	RELEASE TO MARKETING	TH		
	B	TITLE BLOCK ADDED	JF		6/27/13
	C	RIGGING POINTS CORRECTED	JF		8/27/13

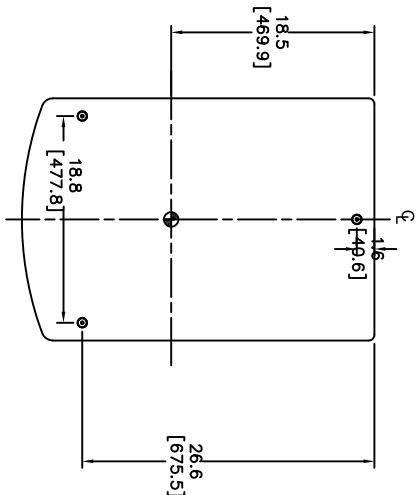

TOP

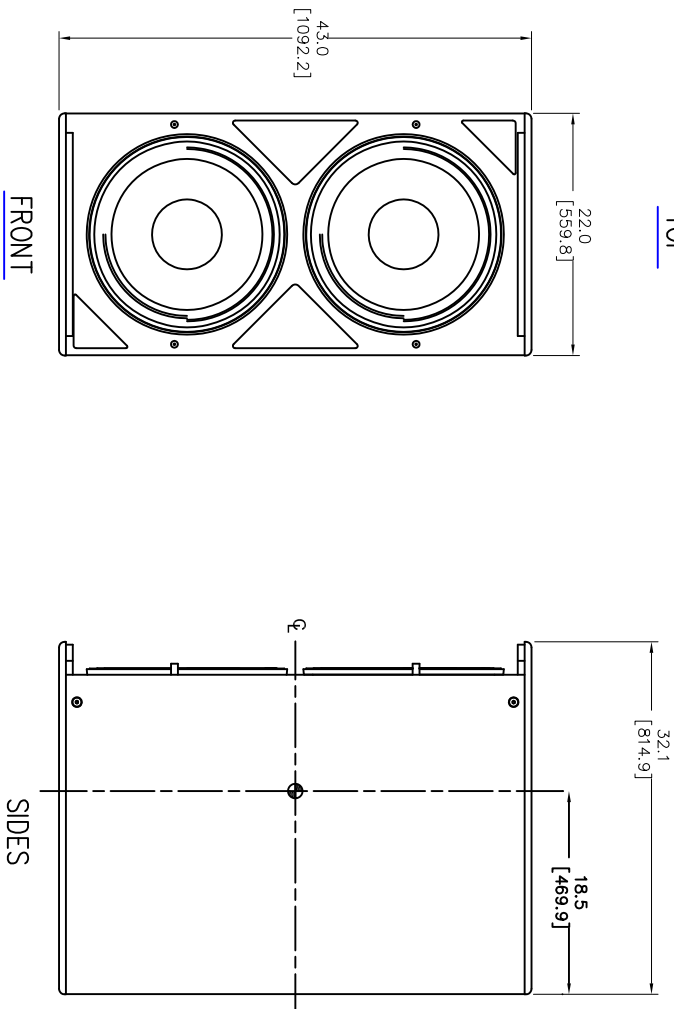

FRONT

SIDES

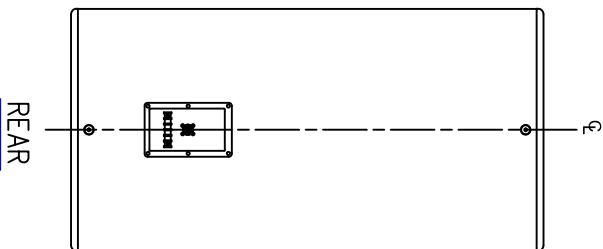

REAR

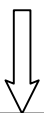

8. CENTER OF GRAVITY (CG)
7. WEIGHT: 73 kg (161 LBS).
6. SUSPENSION POINTS: M10 THREADED SUSPENSION POINTS. 3X TOP, 3X BOTTOM, 2X LEFT, 2X RIGHT, 2X REAR
5. COMPONENTS: LF – 2X 2242H
4. INPUT CONNECTORS: NEUTRIK NL4 IN PARALLEL WITH 4 POSITION TERMINAL STRIP.
3. GRILL: 14 GA. PERFORATED CRS, POWDER COATED BLACK WITH BLACK FOAM BACKING.
2. MATERIALS: 16MM BIRCH PLYWOOD.
1. FINISH: BLACK DURAFLEX (WHITE AVAILABLE BY CUSTOM ORDER)

NOTES: (UNLESS OTHERWISE SPECIFIED)

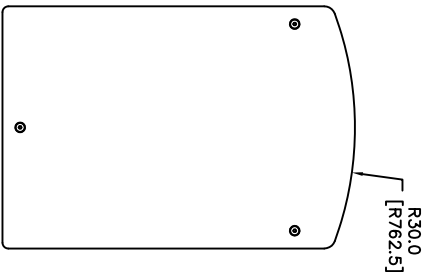

BOTTOM

TOLERANCES (UNLESS OTHERWISE SPECIFIED)

X.XX ± .063 INCH

X.X ± .125 INCH

ANGULAR TOLERANCE OF 0±30°

FRACTIONAL DIMENSIONS ± 1/32

DIMENSIONS ARE INCHES

ALL DIMENSIONS ARE FINISHED DIMENSIONS

DO NOT SCALE DRAWING

JBL PROFESSIONAL
A Harman International Company
Northridge, California 91329 U.S.A.

TITLE

CUSTOMER DRAWING: ASB6128

SIZE

A

DRAWING NO.

1000114287

REV

C

SCALE

NTS

SHEET

1

OF

1